

# VHB2

## Cable Mounting Instructions

### TOOLS YOU NEED

Wire Cutters

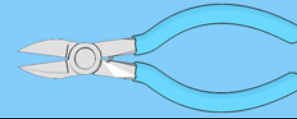

VISION ENGINEERING  
INTELLIGENT LIGHTING SOLUTIONS

1

Push cable through bottom of cable lock.

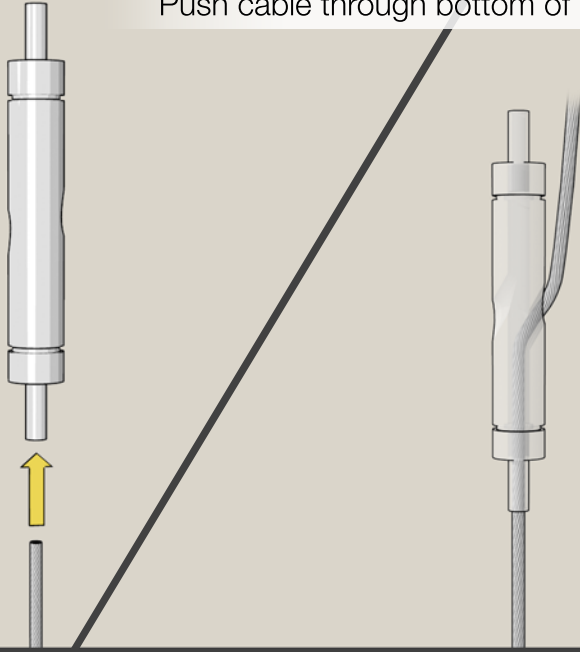

2

Wrap cable around mount and through top of cable lock.

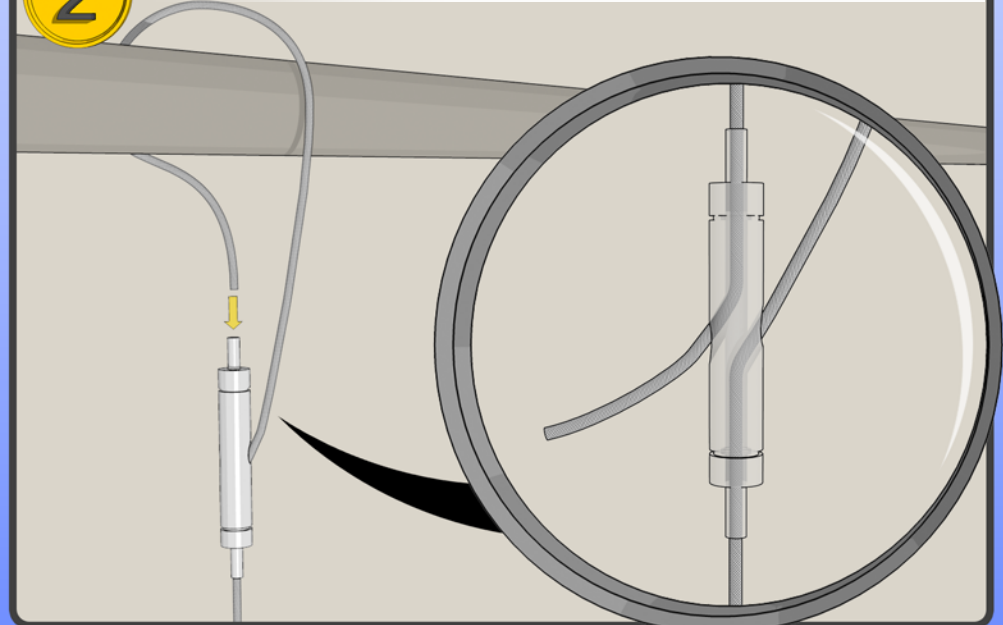

3

Push cable washer through top holes of VHB2.

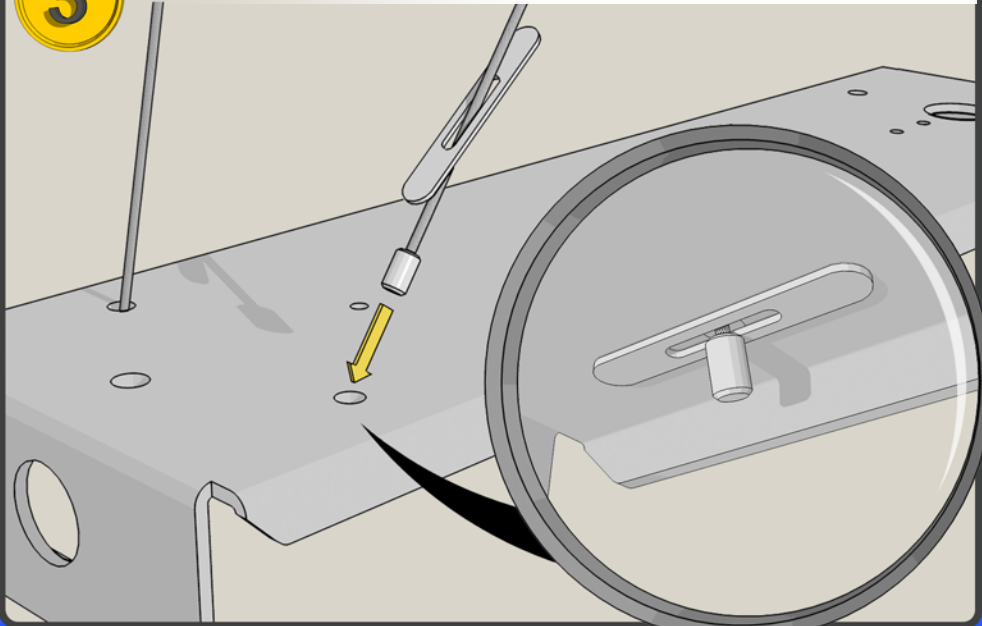

4

Make final adjustments to fixture cable. Cut excess cable with wire cutters.

